

# Steel CABLE CHAIN

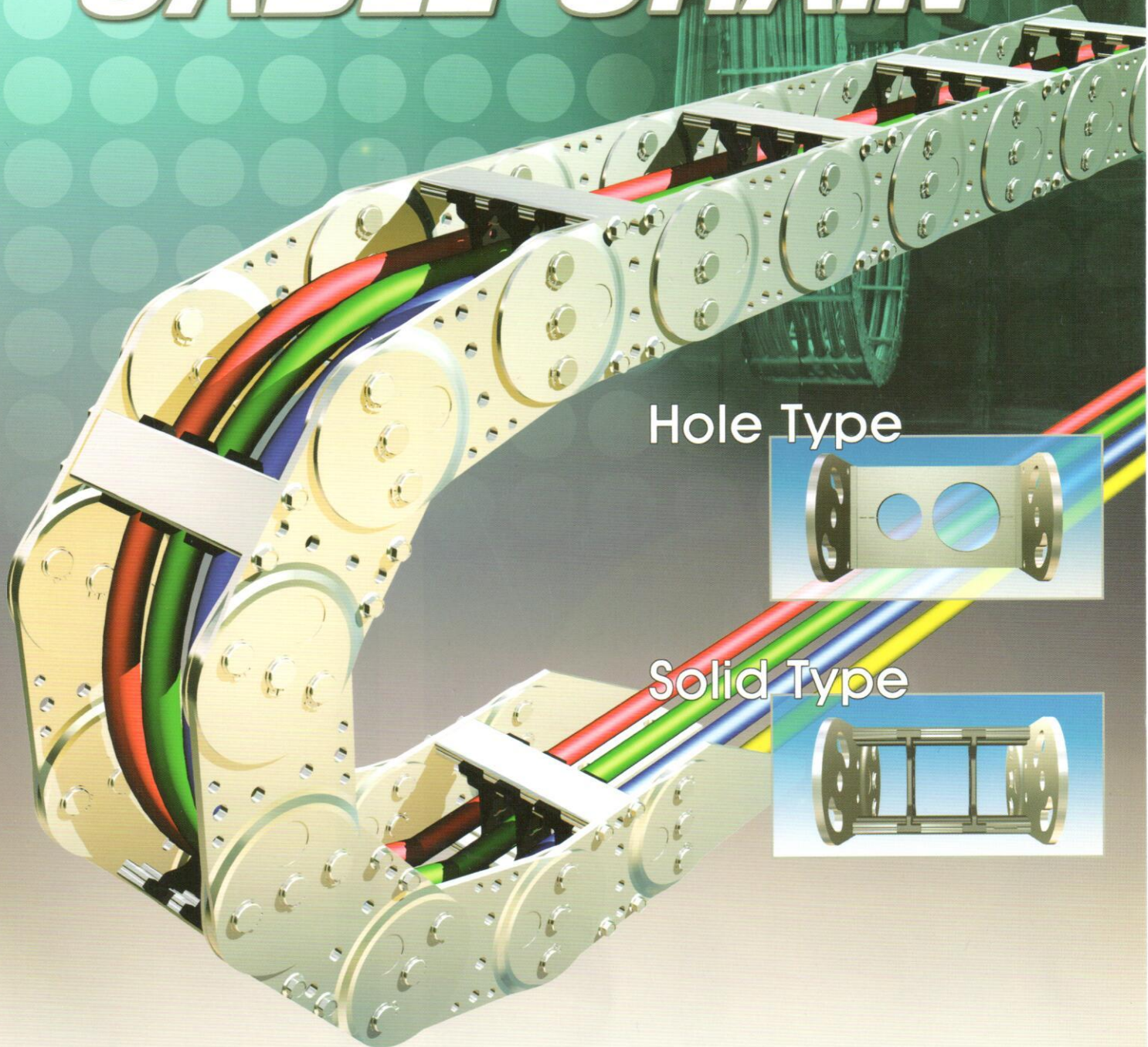

Hole Type



Solid Type



S.K.C 성광기계



# SK 70 STEEL CABLE CHAIN

- Type: SK70
- P: Pitch(70mm)
- Ls: Stroke
- KR: Bending radius
- UB: Loop projection
- LB: Loop length
- Ha: Safe space

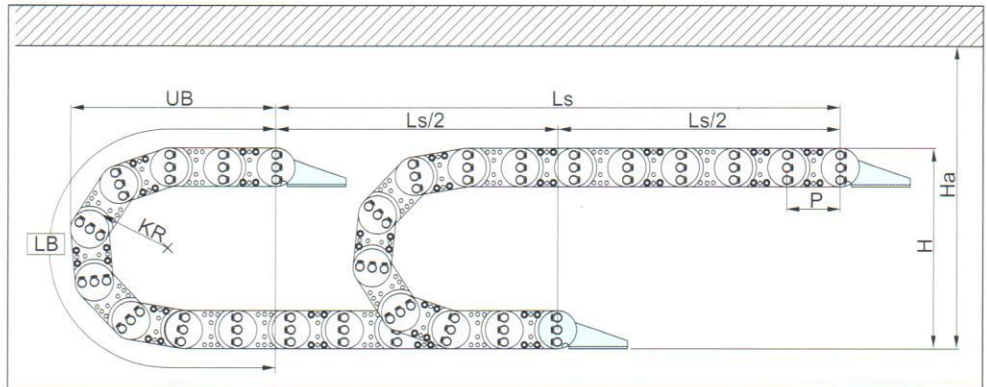

(Dimensions in mm)

곡률반경	KR	75	90	125	145	200
제품높이	H	200	230	300	340	450
설치높이	Ha	210	240	310	350	460
곡선R부	LB	515	560	670	735	910

체인주문길이: 작동거리 1/2+곡선R부= 제품길이

## 시봉 Type

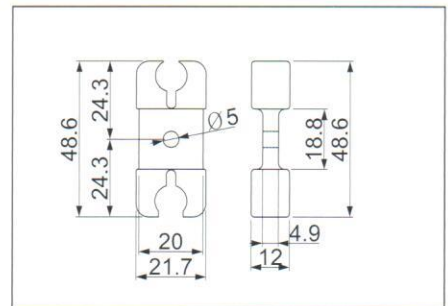
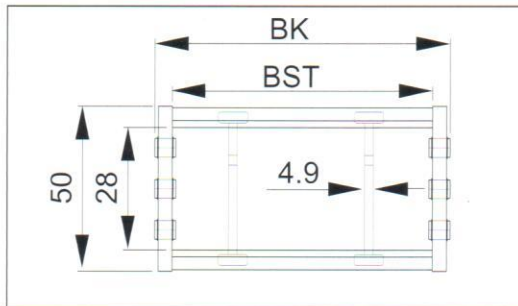
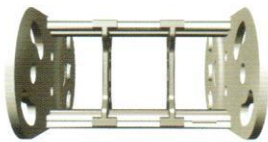

## 기본생산 BK

체인폭BK	100	125	150	175	200	250	300	350
분할대 수	2	2	3	3	4	5	6	7
BST	86	111	136	161	186	236	286	336

## Hole Type

- \* 원형Type
- 스톱트형 Type
- 사각 Type
- 주문에 따라 생산.

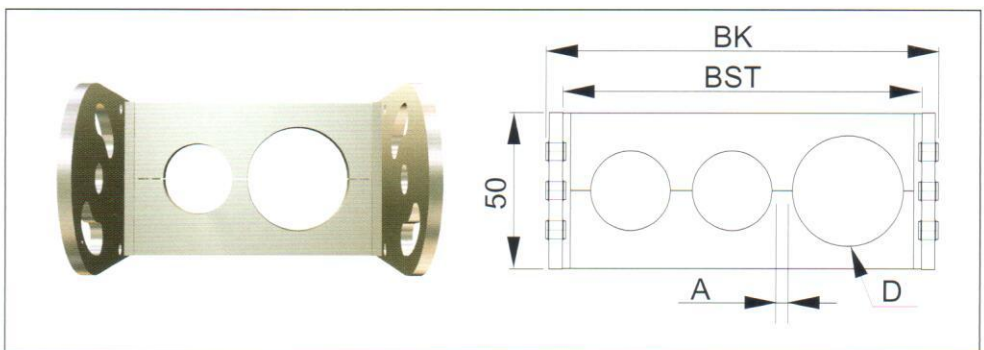

Dmax × 38mm

dmax × 35mm

Amin 5mm

BSTmax × 350mm

# STEEL CABLE CHAIN SK 70



## 체인 카프링

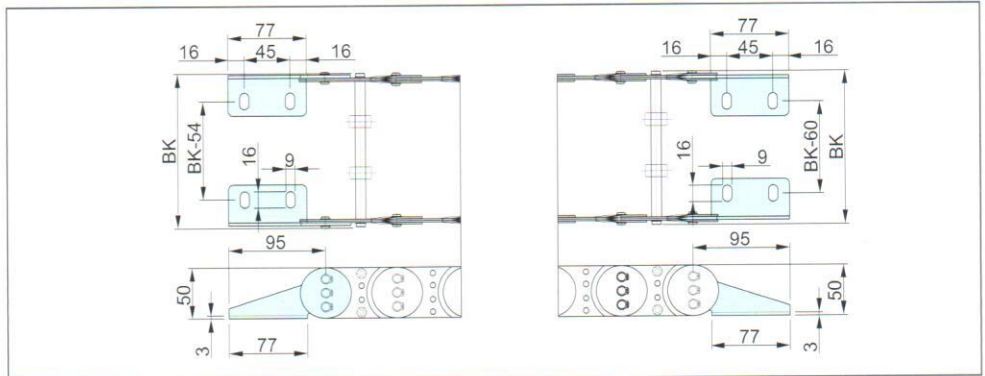

## 체인 홈통

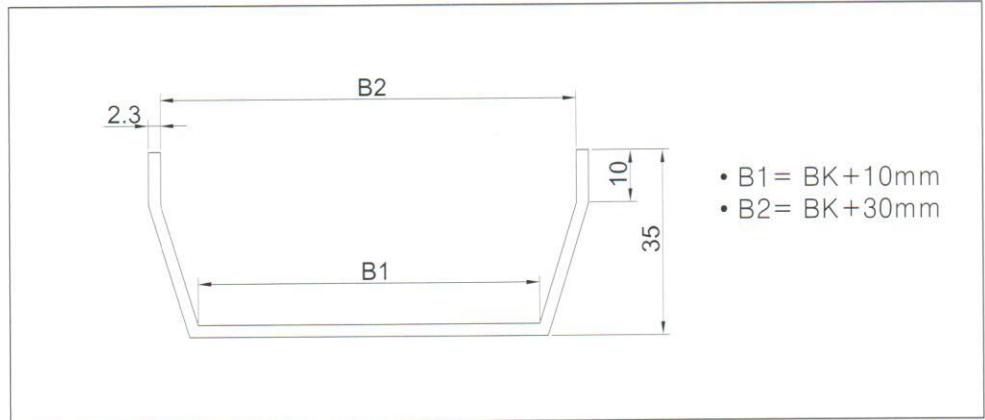

## 체인처짐현상 한계표

- 체인 설치시 사양별 처짐한계표를 참조하여 체인을 선정 및 설치해야 체인처짐현상을 방지할 수 있습니다.

체인사하중 (Kg/m)

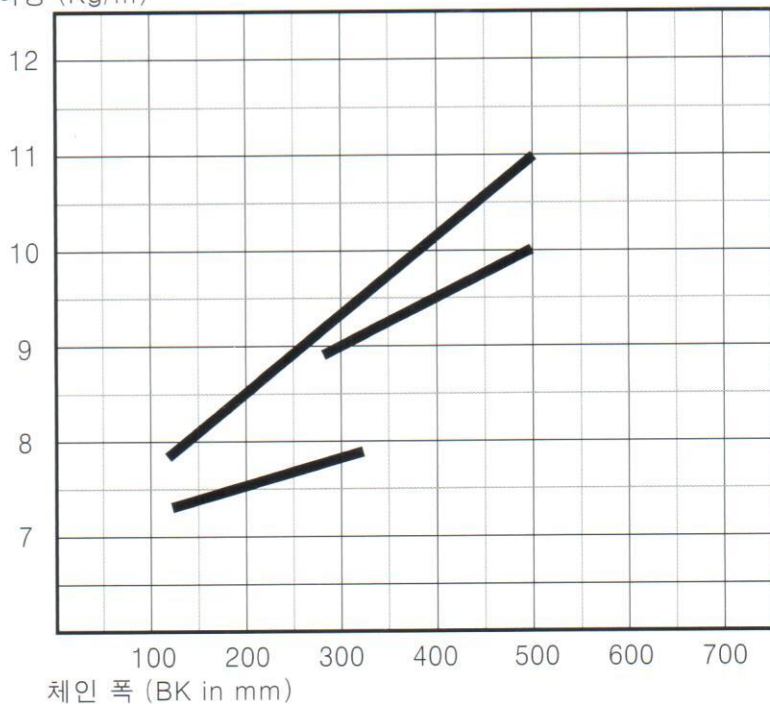



# SK 95 STEEL CABLE CHAIN

- Type: SK95
- P: Pitch(95mm)
- Ls: Stroke
- KR: Bending radius
- UB: Loop projection
- LB: Loop length
- Ha: Safe space

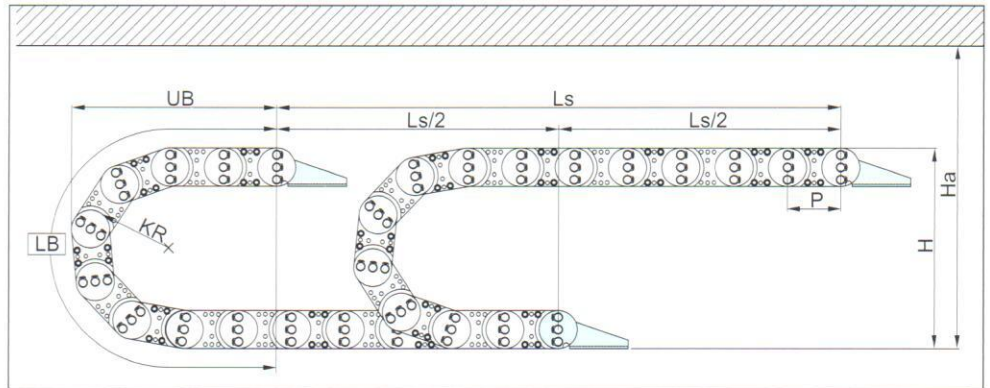

(Dimensions in mm)

곡률반경	KR	125	145	200	250	300
제품높이	H	318	358	468	568	668
설치높이	Ha	330	370	480	580	680
곡선R부	LB	770	835	1000	1165	1320

체인주문길이: 작동거리 1/2+곡선R부= 제품길이

## Solid Type

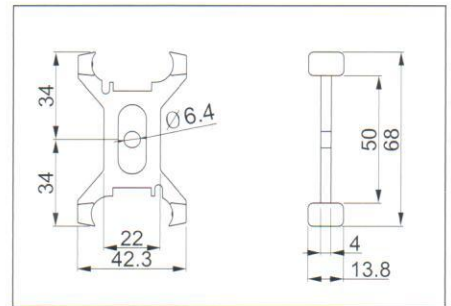
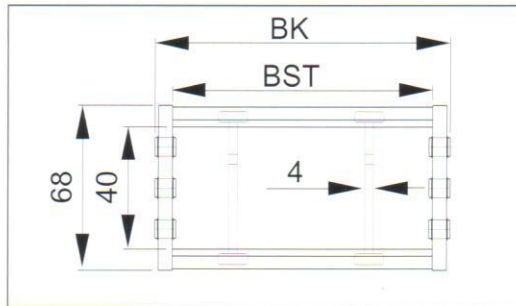
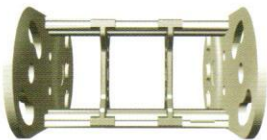

## 기본생산 BK

체인폭BK	100	125	150	175	200	250	300	350	400	450	500	550	600
분할대 수	1	1	2	3	4	5	6	7	8	9	10	11	12
BST	82	107	132	157	182	232	282	332	382	432	482	532	582

## Hole Type

- \* 원형 Type
- 스폿트형 Type
- 사각 Type
- 주문에 따라 생산.

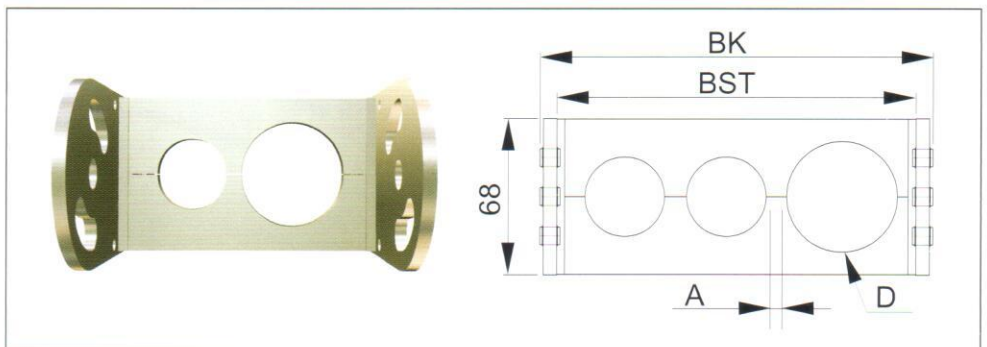

Dmax × 48mm

dmax × 44mm

Amin 5mm

BSTmax × 582mm

# STEEL CABLE CHAIN SK 95



## 체인 카프링

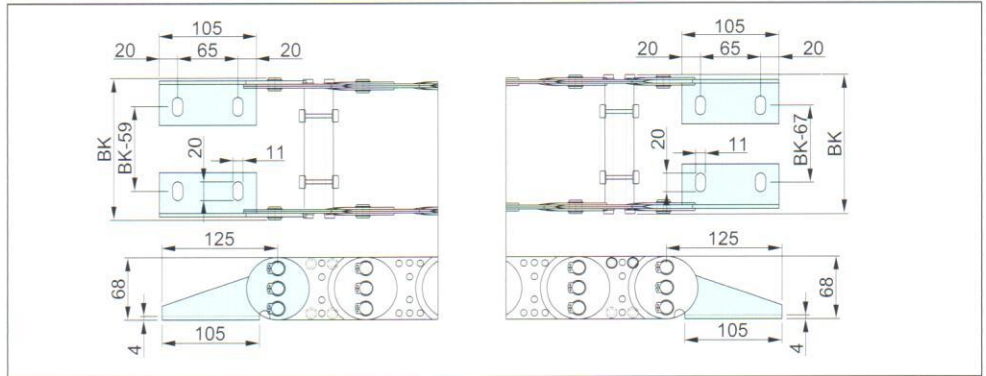

## 체인 홈통

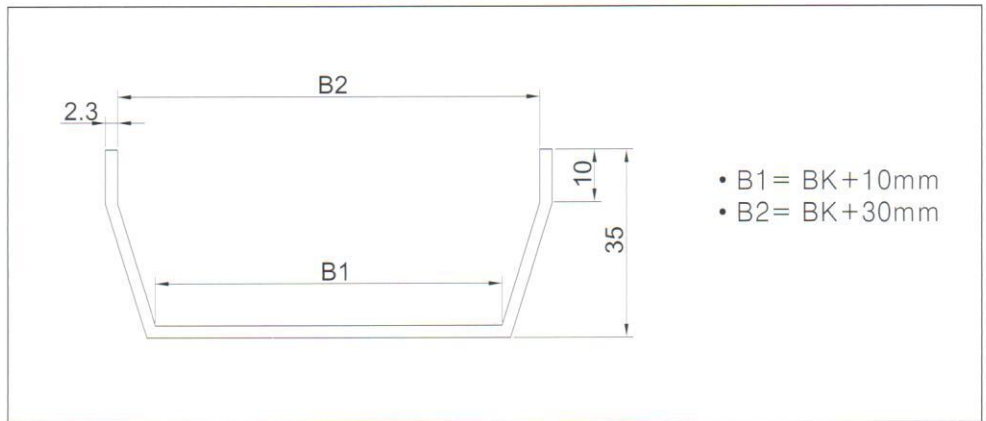

## 체인처짐현상 한계표

- 체인 설치시 사양별 처짐한계표를 참조하여 체인을 선정 및 설치해야 체인처짐현상을 방지할 수 있습니다.

체인사하중 (Kg/m)

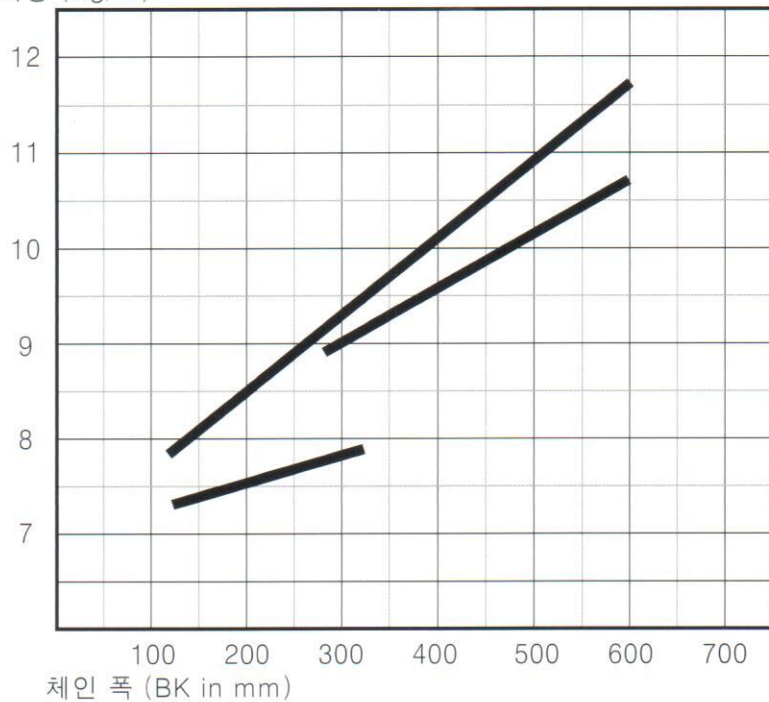



# SK130 STEEL CABLE CHAIN

- Type: SK130
- P: Pitch(130mm)
- Ls: Stroke
- KR: Bending radius
- UB: Loop projection
- LB: Loop length
- Ha: Safe space

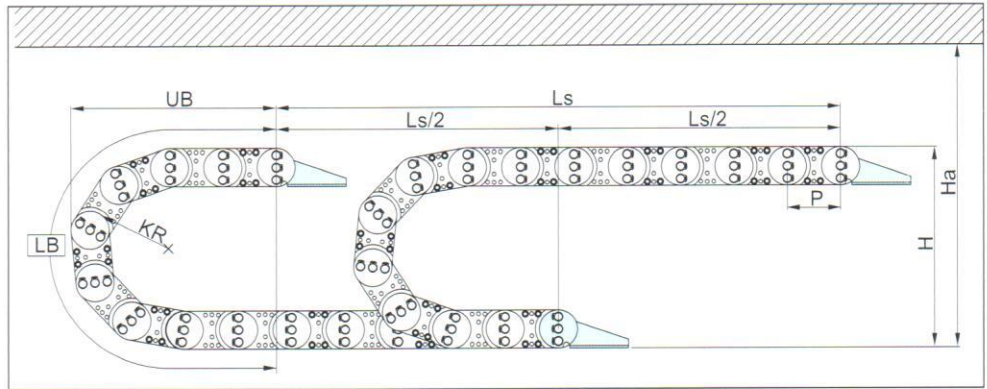

(Dimensions in mm)

곡률반경	KR	150	200	250	300	340	400
제품높이	H	394	494	594	694	774	894
설치높이	Ha	410	510	610	710	790	910
곡선R부	LB	990	1140	1300	1460	1580	1770

체인주문길이: 작동거리 1/2+곡선R부= 제품길이

## Solid Type

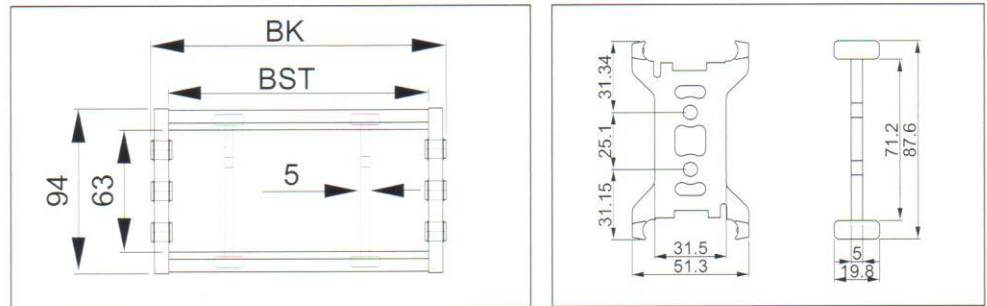
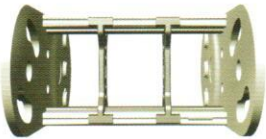

## 기본생산 BK

체인폭BK	200	250	300	350	400	450	500	550	600	650	700	750	800
분할대 수	3	4	5	5	6	6	7	8	9	10	11	12	12
BST	176	226	276	326	376	426	476	526	576	626	676	726	776

## Hole Type

- \*원형Type
- 스롯트형 Type
- 사각 Type
- 주문에 따라 생산.

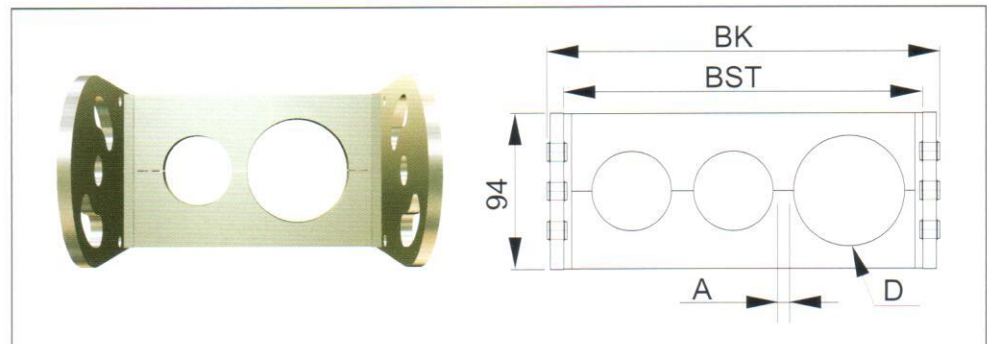

Dmax × 74mm

dmax × 70mm

Amin 5mm

BSTmax × 800mm

# SK130 STEEL CABLE CHAIN

- Type: SK130
- P: Pitch(130mm)
- Ls: Stroke
- KR: Bending radius
- UB: Loop projection
- LB: Loop length
- Ha: Safe space

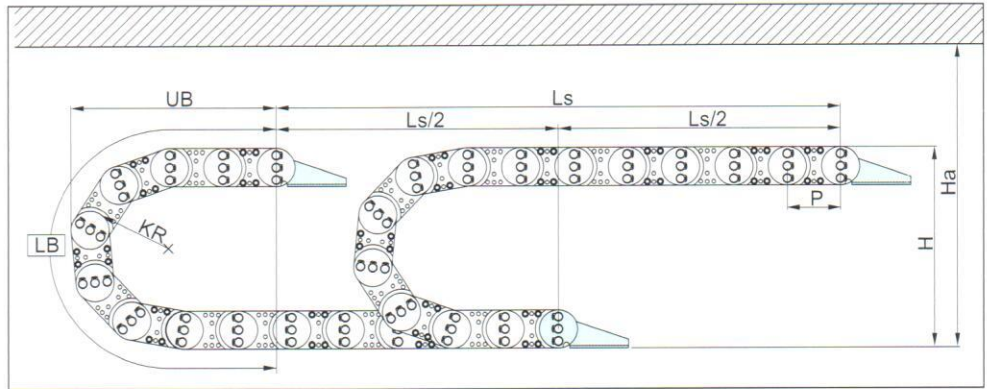

(Dimensions in mm)

곡률반경	KR	150	200	250	300	340	400
제품높이	H	394	494	594	694	774	894
설치높이	Ha	410	510	610	710	790	910
곡선R부	LB	990	1140	1300	1460	1580	1770

체인주문길이: 작동거리 1/2+곡선R부= 제품길이

## Solid Type

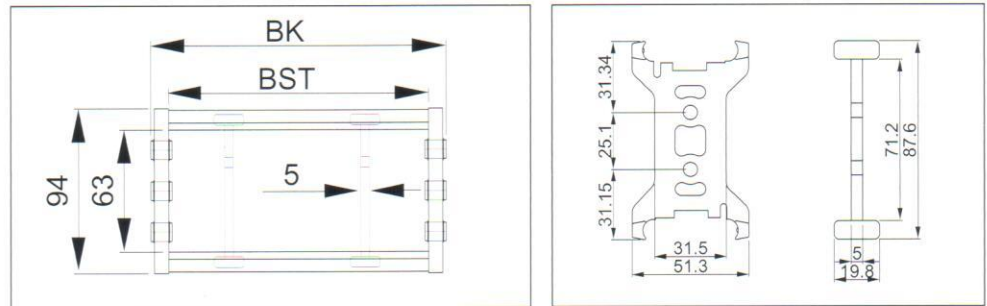
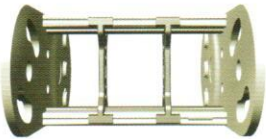

## 기본생산 BK

체인폭BK	200	250	300	350	400	450	500	550	600	650	700	750	800
분할대 수	3	4	5	5	6	6	7	8	9	10	11	12	12
BST	176	226	276	326	376	426	476	526	576	626	676	726	776

## Hole Type

- \*원형Type
- 스폿트형 Type
- 사각 Type
- 주문에 따라 생산.

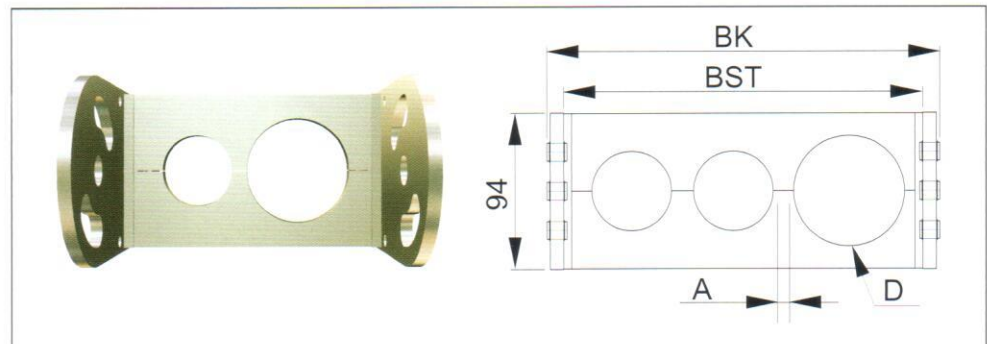

Dmax × 74mm

dmax × 70mm

Amin 5mm

BSTmax × 800mm



# STEEL CABLE CHAIN SK130



## 체인 카프링



## 체인 홈통

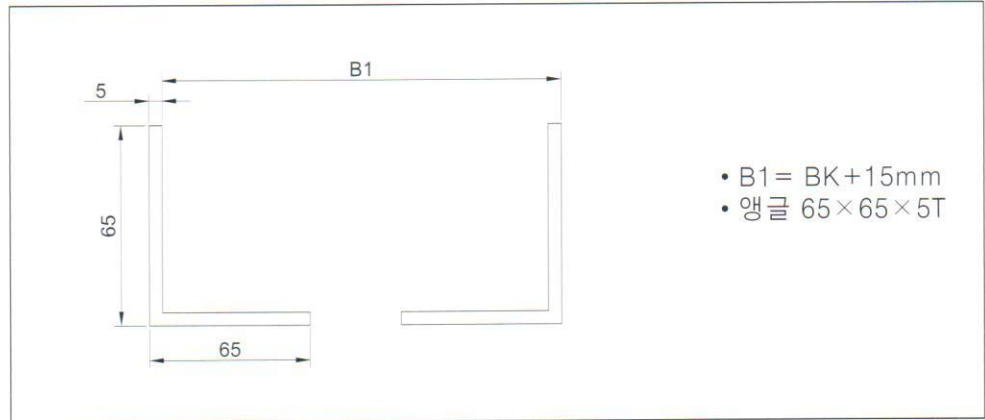

- 체인 설치시 사양별 처짐 한계표를 참조하여 체인을 선정 및 설치해야 체인 처짐 현상을 방지할 수 있습니다.

체인사하중 (Kg/m)

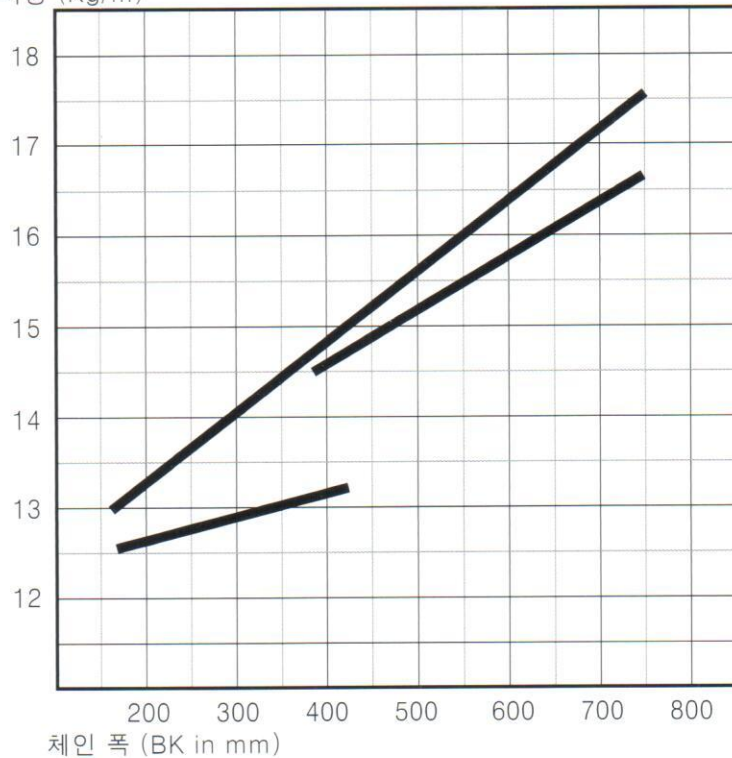



# SK180 STEEL CABLE CHAIN

- Type: SK180
- P: Pitch(180mm)
- Ls: Stroke
- KR: Bending radius
- UB: Loop projection
- LB: Loop length
- Ha: Safe space

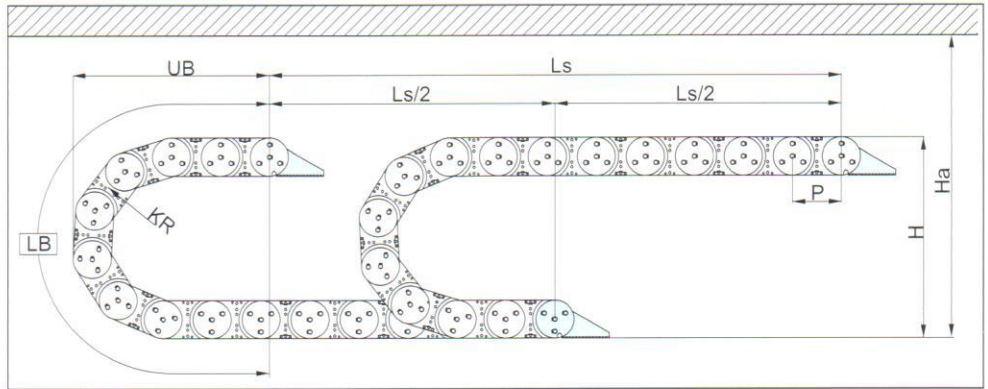

(Dimensions in mm)

곡률반경	KR	250	300	400	500	600	700
제품높이	H	640	740	940	1140	1340	1540
설치높이	Ha	650	750	950	1150	1350	1550
곡선R부	LB	1500	1660	1980	2290	2600	2920

체인주문길이: 작동거리 1/2+곡선R부= 제품길이

## Solid Type

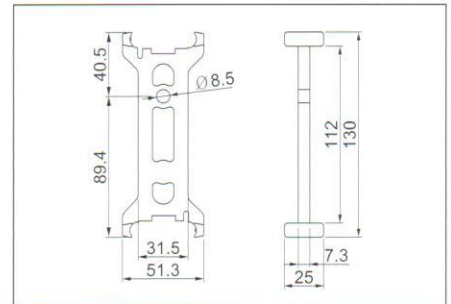
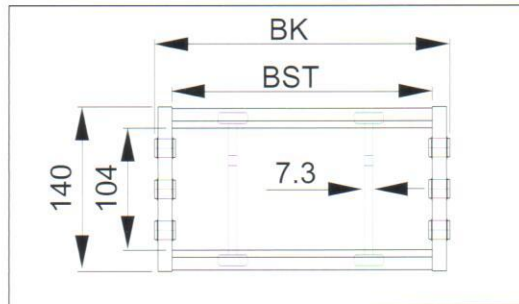
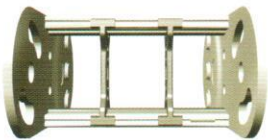

## 기본생산 BK

체인폭BK	200	250	300	350	400	450	500	600	700	800	900	1000	1100
분할대 수	2	3	4	5	6	7	8	9	10	11	12	13	14
BST	171	221	271	321	371	421	471	571	671	771	871	971	1071

## Hole Type

- \* 원형 Type
- 슬롯트형 Type
- 사각 Type
- 주문에 따라 생산.

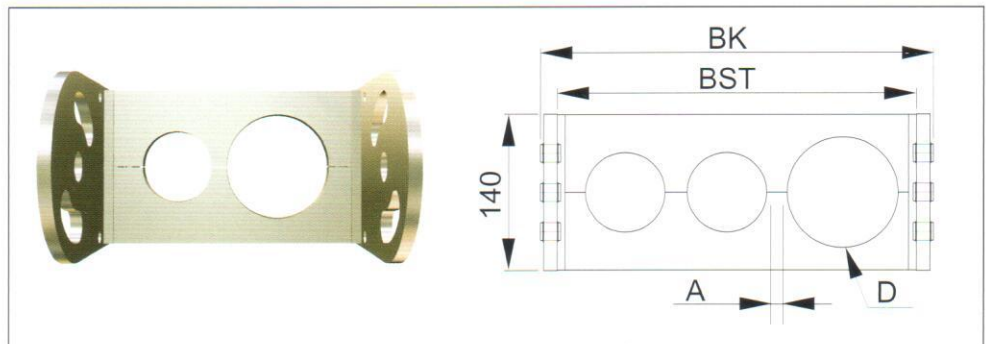

Dmax × 110mm

dmax × 100mm

Amin 6mm

BSTmax × 1071mm

# STEEL CABLE CHAIN SK180



## 체인 카프링

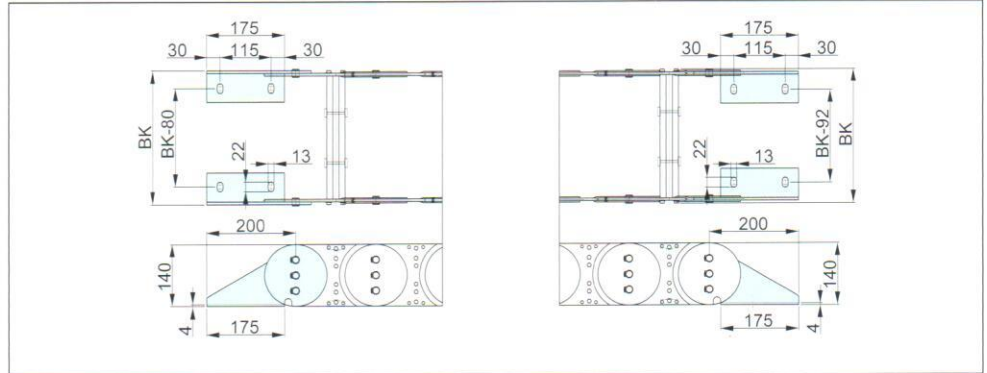

## 체인 홈통

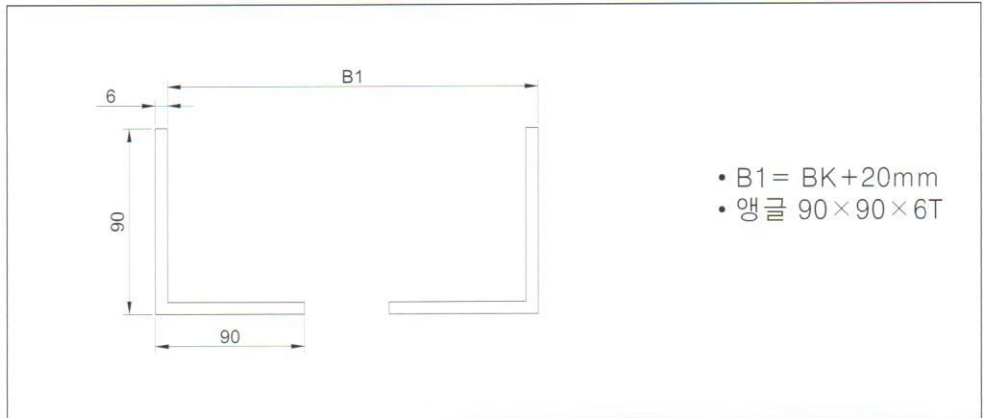

## 체인처짐현상 한계표

- 체인 설치시 사양별 처짐한계표를 참조하여 체인을 선정 및 설치해야 체인처짐현상을 방지할 수 있습니다.

체인사하중 (Kg/m)

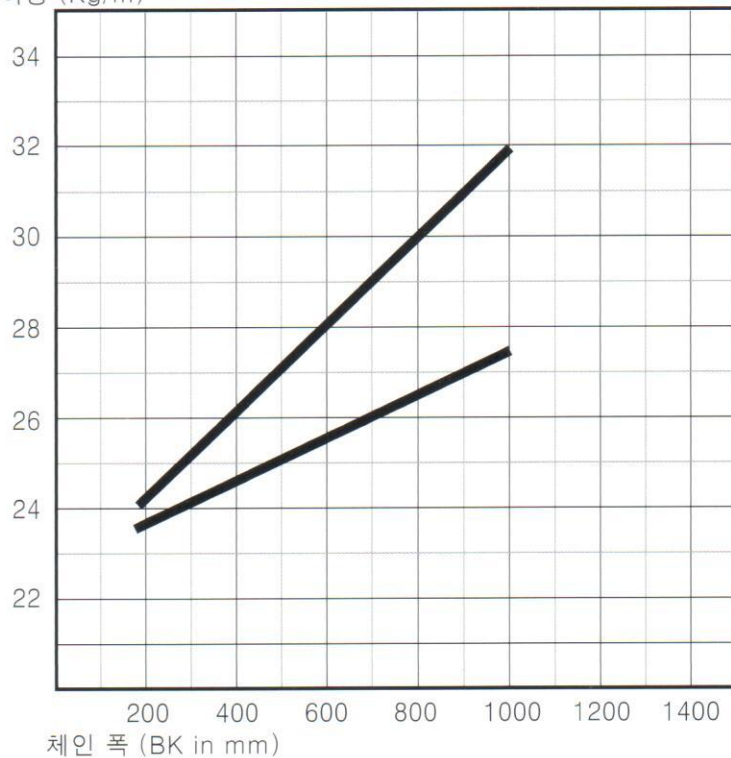



# SK250 STEEL CABLE CHAIN



- Type: SK250
- P: Pitch(250mm)
- Ls: Stroke
- KR: Bending radius
- UB: Loop projection
- LB: Loop length
- Ha: Safe space

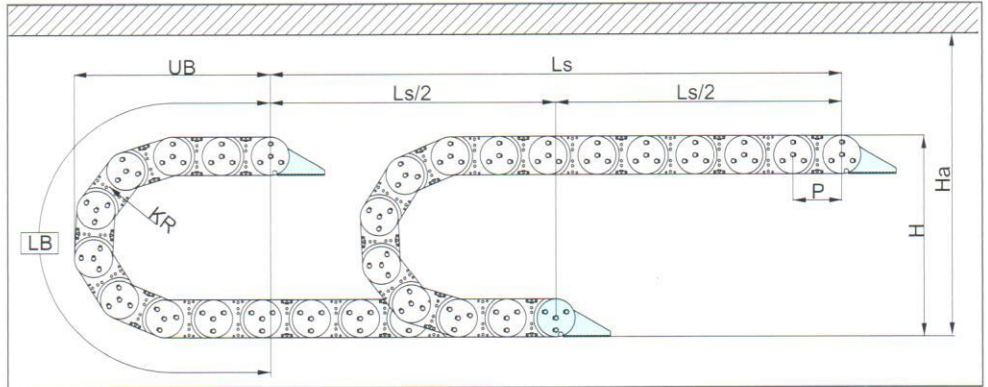

(Dimensions in mm)

곡률반경	KR	350	400	450	600	750
제품높이	H	920	1020	1120	1420	1720
설치높이	Ha	950	1050	1150	1450	1750
곡선R부	LB	2100	2255	2410	2880	3350

체인주문길이: 작동거리 1/2+곡선R부= 제품길이

## Hole Type

- \* 원형 Type
  - 슬롯트형 Type
  - 사각 Type
- 주문에 따라 생산.

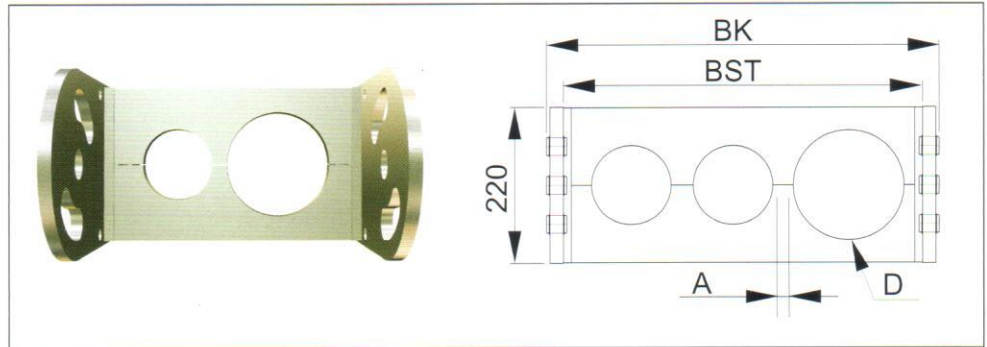

Dmax × 180mm  
Amin 6mm

dmax × 165mm  
BSTmax × 1200mm

## 체인 카프링

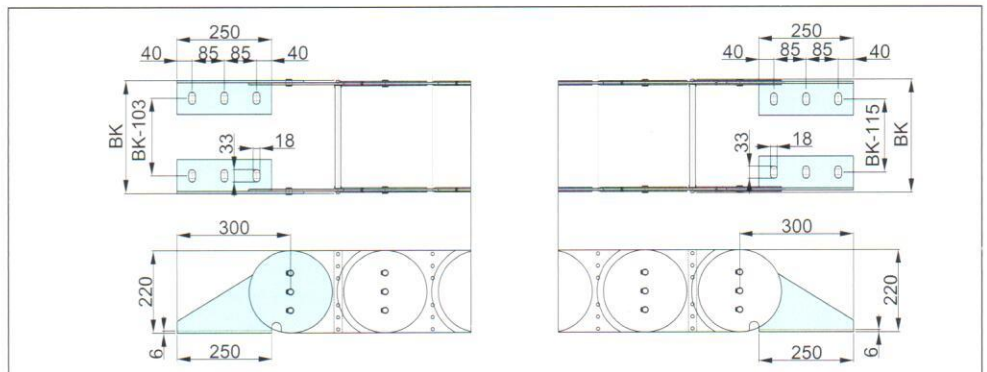

# STEEL CABLE CHAIN SK250



## 체인 홈통

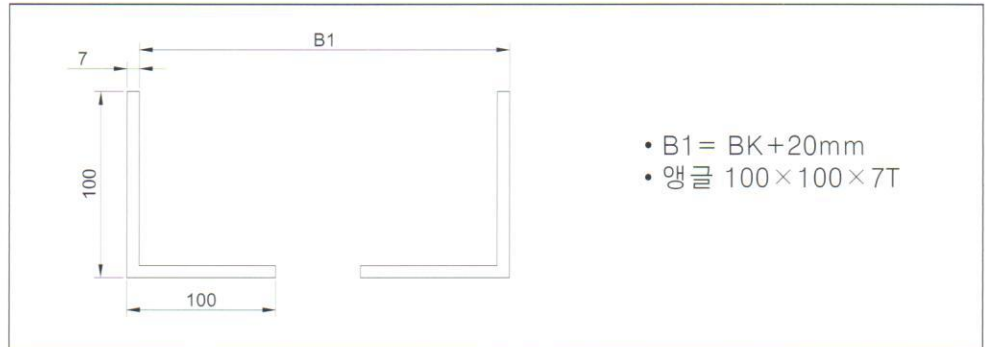

## 체인처짐현상 한계표

- 체인 설치시 사양별 처짐한계표를 참조하여 체인을 선정 및 설치해야 체인처짐현상을 방지할 수 있습니다.

체인사하중 (Kg/m)

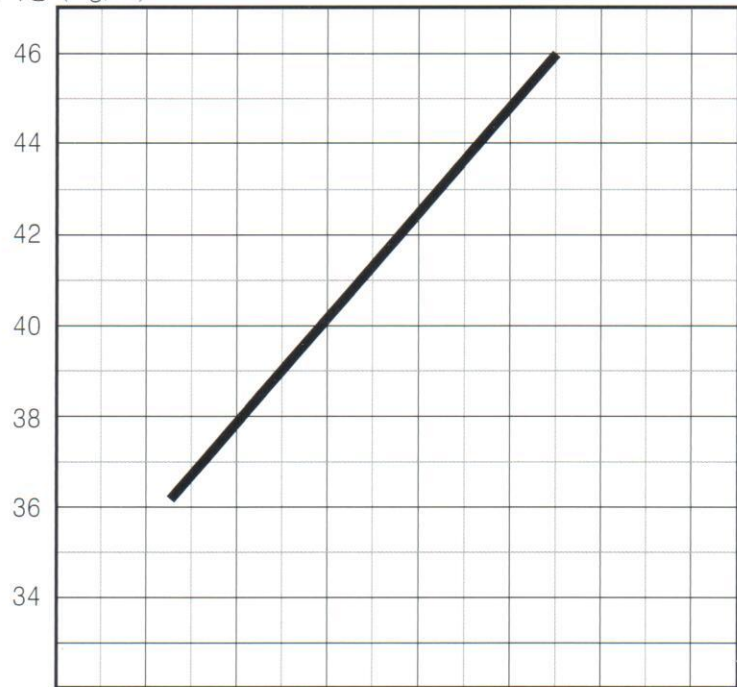

체인 폭 (BK in mm)

## 체인 적용사례

